

**ASSEMBLY
INSTRUCTIONS FOR
HONEYWELL LIMIT
SWITCHES TO 135/155 SERIES
PNEUMATIC ACTUATORS**

MS-INS-UNV-L1
CP Revision B
January, 1998

Kit Contents:

Mounting bracket	Cap screws 3/4" (4)
Coupling screw	Coupling
Cap screws 1-1/2" (4)	Honeywell limit switch
Roll pin	

Refer to Exploded View Throughout Procedure

1. Remove the wall mount bracket (not shown) from the actuator.
2. Press the roll pin into the actuator shaft hole, until it is centered in the shaft.
3. Position and attach the mounting bracket onto the actuator, as shown, with the four 1-1/8" long cap screws.
4. Insert the coupling screw into the non-threaded side of the coupling screw hole as shown. **DO NOT** tighten the coupling screw.
5. Place the coupling over the actuator shaft/roll pin as shown.
6. Position the limit switch assembly onto the mounting bracket. Be sure the limit switch shaft is positioned inside the coupling.

7. Attach the limit switch using the four 1-3/4" long cap screws.
8. Slightly lift the coupling up away from the actuator and tighten the coupling screw until the coupling has clamped onto the limit switch shaft.

NOTE: Cam adjustment instructions are found on Micro Switch instruction sheet located in the switch box.

©1995, 1998 Swagelok Marketing Co.

Swagelok®
www.swagelok.com

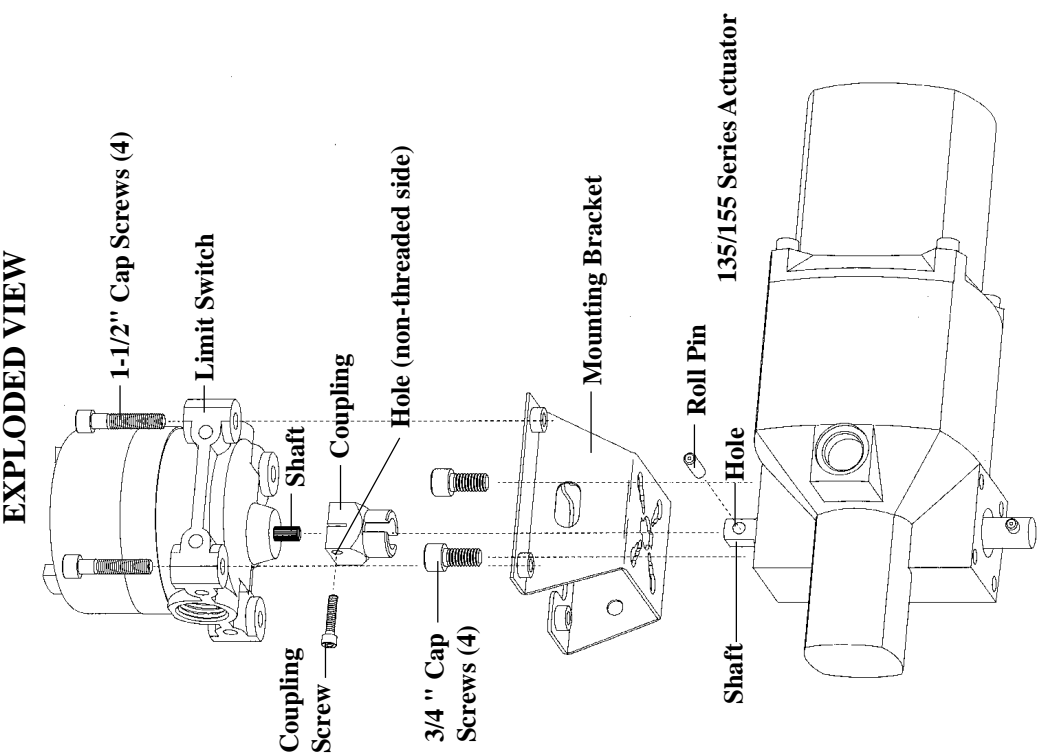

**ASSEMBLY
INSTRUCTIONS FOR
HONEYWELL LIMIT
SWITCHES TO 131/151, 133/153 SERIES
PNEUMATIC ACTUATORS**

MS-INS-UNV-L1
CP Revision B
January, 1998

Kit Contents:

Mounting bracket	Cap screws 1-1/2" (4)
Coupling screw	Coupling
Cap screws, short (4)	Honeywell limit switch
Roll pin	

Refer to Exploded View Throughout Procedure

1. Remove the wall mount bracket (not shown) from the actuator.
2. Press the roll pin into the actuator shaft hole, until it is centered in the shaft.
3. Position the mounting bracket over the actuator shaft/roll pin.
4. Position the mounting bracket with respect to the actuator as shown.
5. Attach the mounting bracket onto the actuator with the four short cap screws.
6. Insert the coupling screw into the non-threaded side of the coupling screw hole as shown. DO NOT tighten the coupling screw.
7. Place the coupling over the actuator shaft/roll pin.

8. Position the limit switch assembly onto the mounting bracket. Be sure the limit switch shaft is positioned inside the coupling.
9. Attach the limit switch using the four 1-3/4" long cap screws.
10. Slightly lift the coupling up away from the actuator and tighten the coupling screw until the coupling has clamped onto the limit switch shaft.

NOTE: Cam adjustment instructions are found on Micro Switch instruction sheet located in the switch box.

©1995,1998 Swagelok Marketing Co.

Swagelok
www.swagelok.com

