

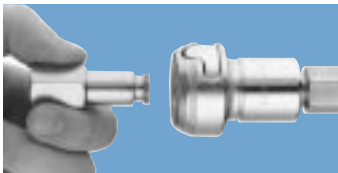

## QTM Series Quick-Connects with Release Button Operation Instructions

### *To Couple:*

Align stem with body.



Push stem into body until it clicks.

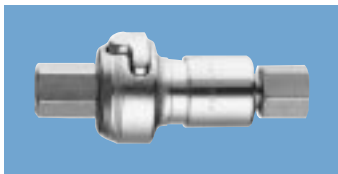

### *To Uncouple:*

Simultaneously press the button, and push the front sleeve toward the rear sleeve.

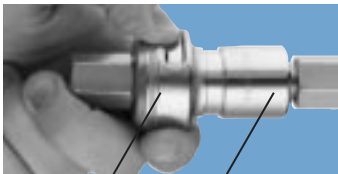

Patented

Front sleeve

Rear sleeve

[www.swagelok.com](http://www.swagelok.com)

These instructions are also available in French, Italian, German and Spanish.

## Good practices for Operations of Swagelok Quick-Connects

- Use filters ahead of quick-connects.
- Use body and stem protectors or dust caps on uncoupled bodies and stems.
- Align bodies and stems when coupling or uncoupling.
- Couple and uncouple quick-connects at room temperature.
- Couple and uncouple quick-connects during system cleaning operations.
- Support hanging hoses or other equipment to prevent side load.
- Relubricate stem seal O-rings periodically.

### Caution:

- Do not rotate under pressure.
- Do not insert foreign objects into uncoupled bodies stems.

### Ratings

Series	Pressure	Temperature
QTM2B	4500 psi (310 bar)	0 to 120°F (-17 to 48°C)
QTM4B and QTM8B	3200 psi (220 bar)	

Swagelok—TM Swagelok Company  
© Swagelok Company  
Printed in U.S.A., CP  
09-01 R1  
MS-CRD-QTMB