

C and CA Series Check Valves Springs, O-Rings, and Gaskets Maintenance Instructions

Tools Required

Valve	Size in.	Part
CA	5/8	Inlet and outlet body hex
2C, 2C2, 2C4, 4C, 4C1, 4C2, 4C-VCR, 6C-MM	5/8	
4C4	3/4	
6C, 6C2, 6C4, 8C, 8C2, 8C-MM, 10C-MM, 12C-MM	7/8	
8C-VCR	15/16	
8C4	1 1/16	
12C, 12C2, 12C4	1 1/4	
16C	1 3/8	
12C-VCR, 16C2, 16C4, 16C-VCR	1 5/8	Center body hex
CA	9/16	

Valve	Size in.	Part
CA	5/32	Locking screw, adjusting screw

Tools Required

Valve	Capable of:
CA	150 in.-lb (17.0 N-m)
2C, 4C, 6C-MM	100 in.-lb (11.3 N-m)
6C, 8C, 8C-MM, 10C-MM, 12C-MM	200 in.-lb (22.6 N-m)
12C, 16C	700 in.-lb (79.1 N-m)

- WARNING**
Before servicing any valve, you must
- depressurize system
 - cycle valve
 - purge valve
- WARNING**
Residual material may be left in the valve and system.
- WARNING**
Do not scratch any internal surfaces while following these instructions. Valve performance could be affected.

Definition of Symbols



Discard if replacing with new component



Lubricate with system compatible lubricant

C Series Check Valves

Spring Kit

- Spring
- Labels (2)
10 PSI

O-Ring Kit

- O-ring

Gasket Kit

- Inlet gasket

Exploded View

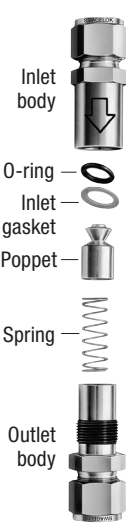

Disassembly

-
-
-

Reassembly

-
-
-
-

12C, 16C series valves: Place the **inlet gasket** on top of the O-ring in the **inlet body** bore.

-
-

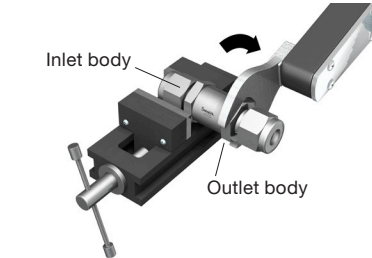

Valve	Valve Material	Torque Value in.-lb (N-m)
2C, 4C, 3C 6C-MM	All	100 (11.3)
6C, 8C, 8C-MM, 10C-MM, 12C-MM	Brass	150 (17.0)
	All other	200 (22.6)
12C	Brass	350 (39.6)
16C	All other	700 (79.1)

- WARNING**
There should be an external gap between body pieces. Do not overtighten.
- -

10. Install the valve while holding the **hex** closest to the **valve end** being installed.

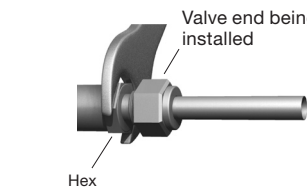

CA Series

Spring Kit

- Spring
- Label (2)
3 to 50 PSI

O-Ring Kit

- O-ring

Gasket Kit

- Inlet gasket
- Outlet gasket

Exploded View

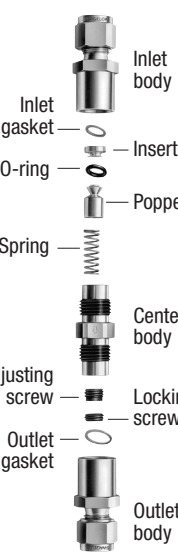

Disassembly

-
-
-
-

-
-

Reassembly

-
-
-
-

-
-

-
-

Valve Material	Torque Value in.-lb (N-m)
Brass	85 (9.6)
All other	150 (17.0)

-
-
-
-
-

Translations available on www.swagelok.com



CP and CPA Series Pipe-Ended Check Valves

Springs, O-Rings, and Gaskets Maintenance Instructions

Tools Required

Hex Wrench		
Valve Series	Size in.	Part
4CPA	5/32	Locking screw, adjusting screw
8CPA	5/16	
Hex Bit Socket		
Valve Series	Size in.	Part
4CP, 4CPA	3/16	Insert lock screw
8CP, 8CPA	3/8	
Torque Wrench		
Valve Series	Capable of:	
4CP, 4CPA	85 in.-lb (9.6 N-m)	
8CP, 8CPA	300 in.-lb (33.9 N-m)	

- WARNING** Before servicing any valve, you must
 - depressurize system
 - cycle valve
 - purge valve
- WARNING** Residual material may be left in the valve and system.
- WARNING** Do not scratch any internal surfaces while following these instructions. Valve performance could be affected.

Definition of Symbols

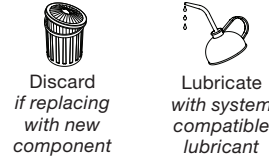

CP Series

Spring Kit



O-Ring Kit



Exploded View

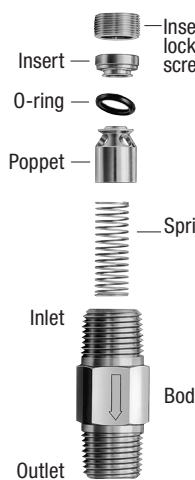

Disassembly

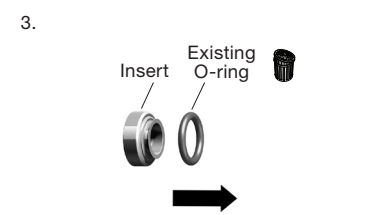
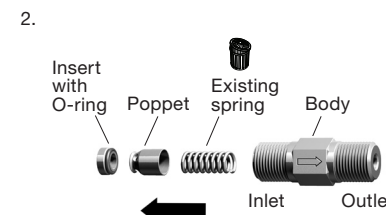
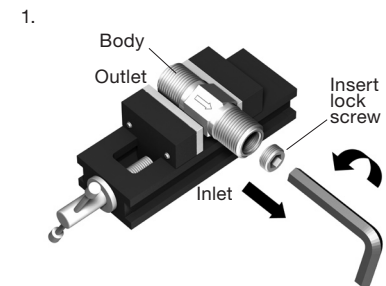

4. Make sure all components are clean.

Reassembly

1. Lubricate the **O-ring** and install it on the **insert**. *Note: PTFE O-rings require factory assembly.*

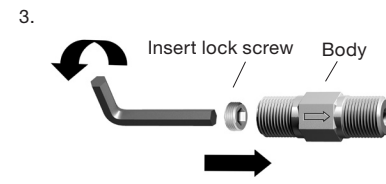
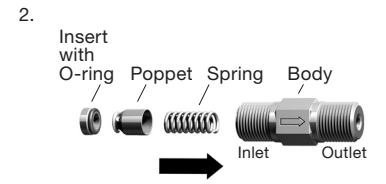
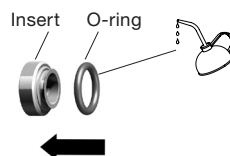

4. Tighten the **insert lock screw** according to the table.

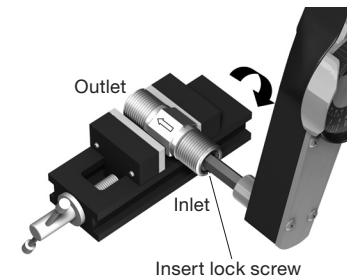

Valve Series	Valve Material	Torque Value in.-lb (N-m)
4CP	Brass	45 (5.1)
	All other	85 (9.6)
8CP	Brass	100 (11.3)
	All other	300 (33.9)

5. Test product prior to installation in the system.
6. Attach the new label to the **body** hex.

CPA Series

Spring Kit



O-Ring Kit



Exploded View

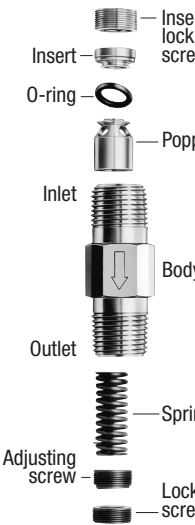

Disassembly

1. Loosen the **locking screw**.

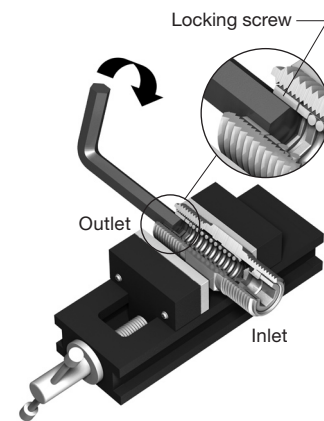

2. Slide the hex wrench down into the **adjusting screw** and loosen.

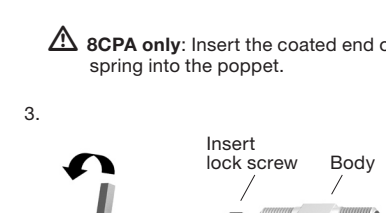
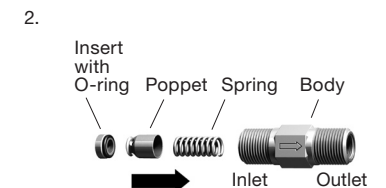
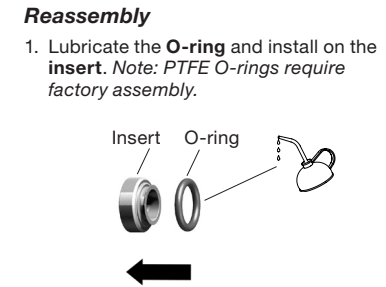
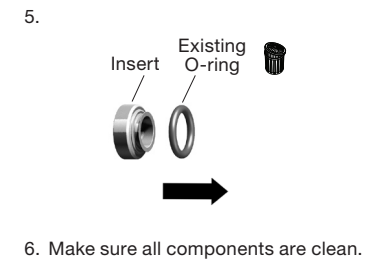
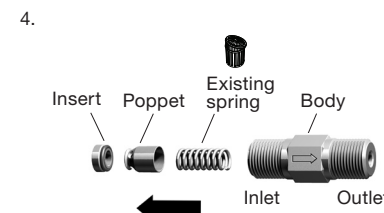
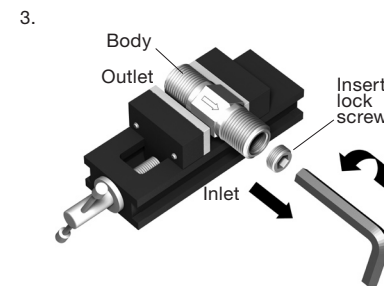
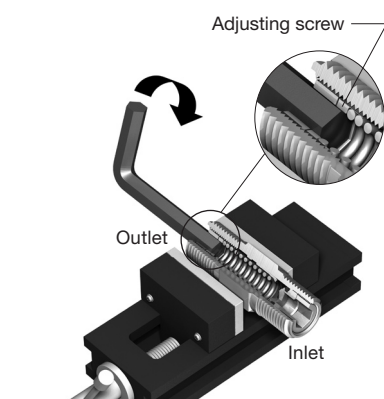

3. **8CPA only:** Insert the coated end of spring into the poppet.



4. Tighten the **insert lock screw** according to the table.

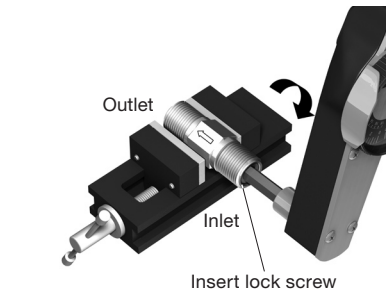

Valve Series	Valve Material	Torque Value in.-lb (N-m)
4CPA	Brass	45 (5.1)
	All other	85 (9.6)
8CPA	Brass	100 (11.3)
	All other	300 (33.9)

5. Turn the **adjusting screw** clockwise to increase the cracking pressure; counter-clockwise to decrease cracking pressure.

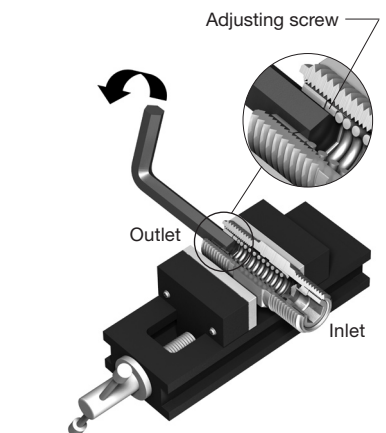

6. Slide the hex wrench back up into the **locking screw** and turn clockwise to lock.

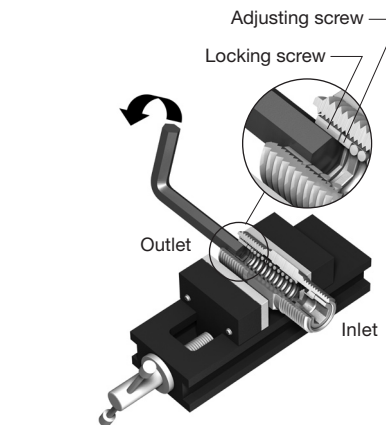

7. Test product prior to installation in the system.
8. Attach the new label to the **body** hex.