

WELD ARGON PANEL

Features and Benefits

- Compact
- 5 outlets
- Wall mount ready
- Built with high-quality Swagelok components

Materials of Construction

- Swagelok ELD8 Series Isolation Valve
- Swagelok KPR Series Regulator
- Swagelok PGU Series Pressure Gauge
- Swagelok GP Series 5–50 SCFH Flow Meters
- Swagelok VCR® and MicroFit® Fittings

Technical Information

- Maximum inlet pressure 300 psig
- Maximum temperature rating 212°F
- Regulator pressure control range 0–50 psig
- Flow range 5–50 SCFH
- For inert gas use only

Testing, Cleaning, and Packaging

- Inboard Helium Leak Tested to 1×10^{-9} std cm³/s
- Assembled and packaged in Class 100 Cleanroom
- Particle count certificate available upon request

Additional Purge Solutions

- Purge Trees
- UHP Purge Sticks
- Purge Jumpers
- Weld Purge Panel
- Purge Fitting Kits

For product technical data, including materials of construction, see the following catalogs:

[Swagelok LD Series Diaphragm Valves MS-0-172](#)

[Swagelok K-Series Regulators MS-02-230](#)

[Swagelok PGU and PGC Series Pressure Gauges MS-02-163](#)

[Swagelok G Series and M Series Variable Area Flowmeters MS-02-346](#)

[Swagelok VCR® Metal Gasket Face Seal Fittings MS-01-24](#)

[Swagelok Weld Fittings MS-01-149](#)

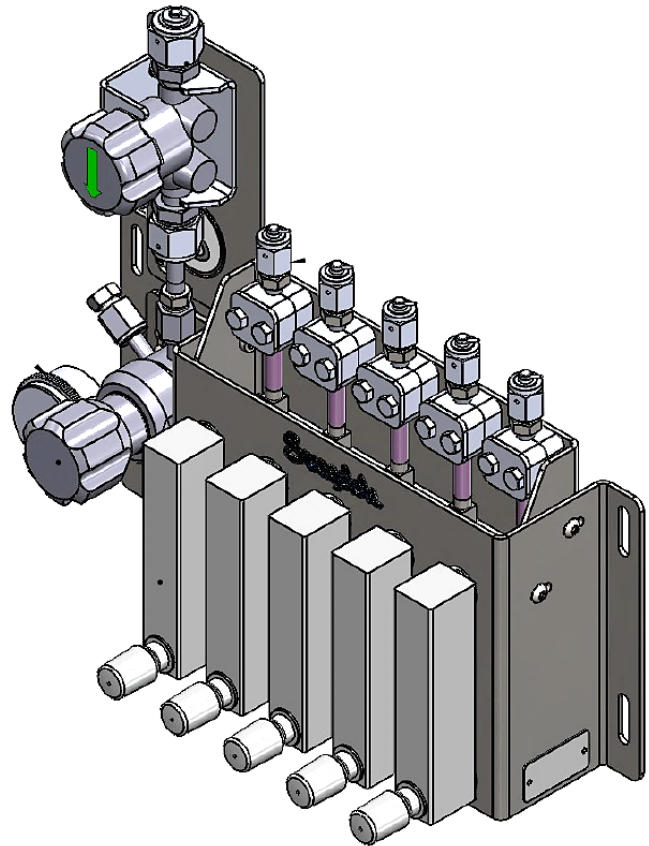

Swagelok

Dimensions

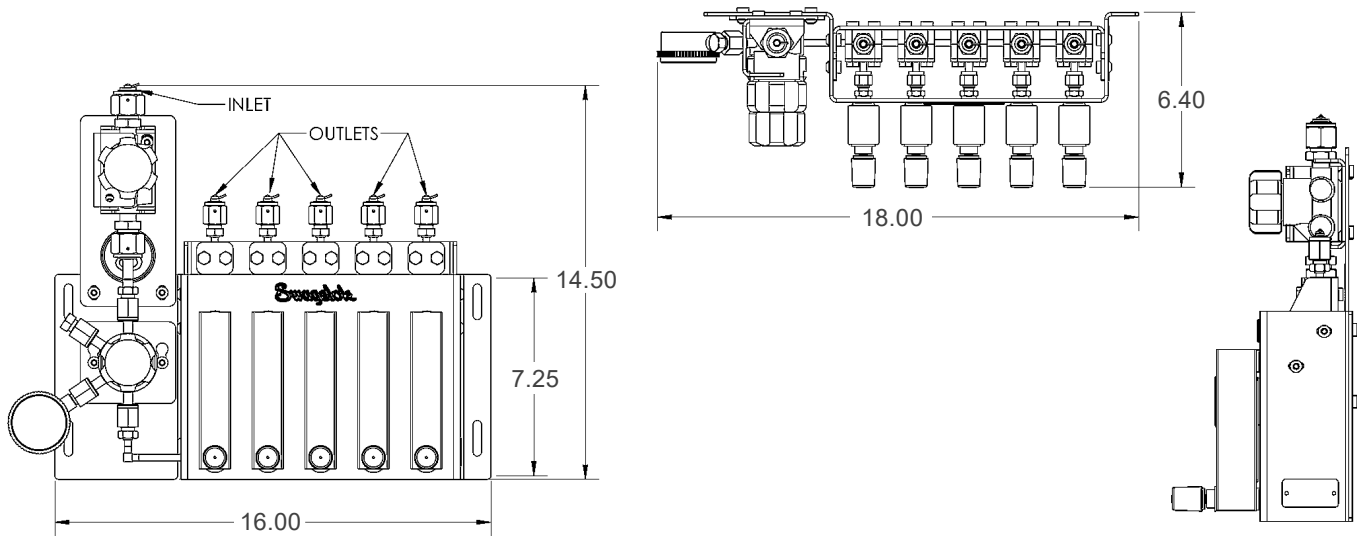

Dimensions are in inches.

Ordering Information

Build Weld Argon Panel ordering number by combining the designators in the sequence shown below.

WP 1 2 3 4 5 6
WP - 8 M 4 M - 5 - O

1 END CONNECTION SIZE 1

8 = 1/2"

2 END CONNECTION 1

M = Male VCR

3 END CONNECTION SIZE 2

4 = 1/4"

4 END CONNECTION 2

M = Male VCR

5 FLOWMETER RANGE

5 = 5–50 SCFH Argon

6 GAUGE(S)

O = Outlet Gauge Only

I = Inlet and Outlet Gauge

Safe Product Selection

When selecting a product, the total system design must be considered to ensure safe, trouble-free performance. Function, material compatibility, adequate ratings, proper installation, operation, and maintenance are the responsibilities of the system designer and user.

Caution: Do not mix or interchange parts with those of other manufacturers.

Warranty Information

Swagelok products are backed by The Swagelok Limited Lifetime Warranty. For a copy, visit swagelok.com.



Swagelok Southwest

Phoenix (602).268-4848

Albuquerque (505) 842-0213

ssw@swagelok.com