

MEASURING UP



WHAT YOU'VE COME TO EXPECT:

Swagelok Industrial and Process Pressure Gauges deliver unparalleled accuracy while monitoring vacuum and positive system pressures up to 15,000 psi, 1000 bar, or 100 MPa.

What you might not know:

Swagelok Gauges, when employed with Swagelok tube fittings and Swagelok tube adapters, solve challenging alignment problems as safely and easily as...

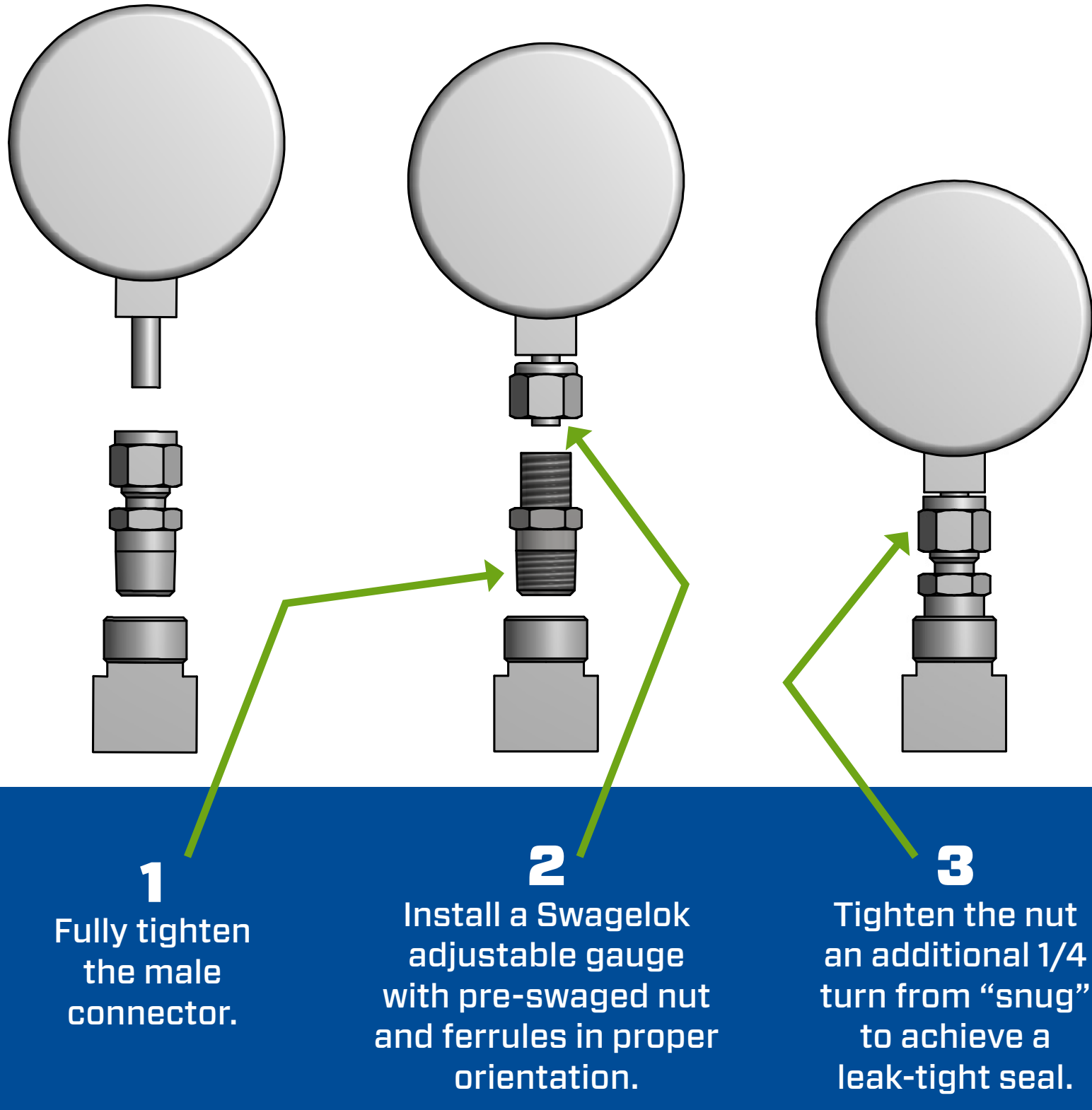

1

Fully tighten the male connector.

2

Install a Swagelok adjustable gauge with pre-swaged nut and ferrules in proper orientation.

3

Tighten the nut an additional 1/4 turn from "snug" to achieve a leak-tight seal.

Best of all, there's virtually no chance to damage the gauge!

- All Swagelok Gauges are factory-calibrated and pressure-tested.
- Available with a wide variety of end connections (in addition to Tube Adapters).
- Constructed of stainless steel and reinforced thermoplastic.
- Order unfilled or liquid-filled.
- Sizes: 40, 50, 63, 100, 115, and 160 mm dials.
- Styles: General Purpose, Solid-Front, Miniature, Low-Pressure, and more.



Click Here
to view our gauges

Get a more in-depth read on why genuine Swagelok is the global fluid-system industry's most reliable brand of componentry and supplementary strategic services:

PREMIER
PRODUCTS

STRATEGIC
SERVICES

APPLICATION
EXPERTISE

Our Promise:

In each and every customer engagement and interaction, no matter how challenging your application or operating conditions, we will deliver premier-quality Swagelok Fluid-System Product Solutions and value-added Strategic Services that will make you safer, more productive, more efficient, and more profitable.



WE CAN HELP YOU SAVE TIME, MONEY, AND WORRY:



Swagelok Pittsburgh | Tri-State Area

49 Meade Avenue

Pittsburgh, PA 15202

412.761.3212

f Like

🐦 Tweet

in Share

✉ Forward

You are receiving this email as a valued contact of Swagelok

Pittsburgh | Tri-State Area.

[Preferences](#) | [Unsubscribe](#)