



# Gas Distribution Systems

Swagelok understands that conveying gas from one point to another is a challenging job. Customers are faced with tight operational challenges. Corrective maintenance, lengthy shutdowns - any of these will cause loss of revenue or product defects on the productions and eventually decrease productivity. The last thing you want to worry about is a leaking or failed component. Easy to install and operate, these solutions offer high quality and the support you can expect from Swagelok.

Swagelok Gas Distribution Systems are highly configurable and customizable depending on application or the challenges that you are facing. Our Gas Distribution System is also assembled from Swagelok high quality components that ensure safe, reliable and leak free application.

Gas distribution systems work to deliver gases from a high-pressure source to the facility at the pressure and flow rate required by each application.

## Gas distribution systems have four typical subsystems:

- Source inlet connection
- Primary gas pressure control
- Point-of-use
- Automatic changeover



## Swagelok has four standard types of systems available that cover the four typical subsystems:

- **Swagelok® Source Inlet (SSI)**  
covers source inlet connection subsystem
- **Swagelok® Gas Panel (SGP)**  
covers primary gas pressure control subsystem
- **Swagelok® Point-of-Use (SPU)**  
covers point-of-use subsystem
- **Swagelok® Changeover (SCO)**  
covers automatic changeover subsystem

## The advantages of Swagelok gas distribution systems:

- Highly configurable
- Components within the systems can be easily removed or replaced for maintenance
- Reliable and long-lasting performance

## Swagelok® Source Inlet (SSI)

Swagelok® Source Inlet (SSI) is used for extra control in heavy gas usage before primary gas pressure control. SSI typically includes isolation, vent, and purge options. Additionally, there will be hoses or tubing pigtailed to connect each bottle to the manifold.

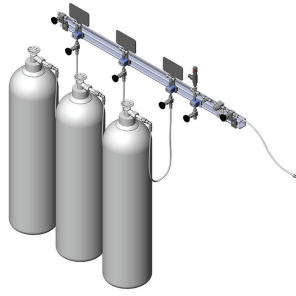

## Swagelok® Gas Panel (SGP)

Swagelok® Gas Panel (SGP) is used predominantly to reduce gas pressure at or near the source prior to a larger gas distribution network. These systems can be built with either single or dual stage pressure regulation to accurately deliver gas while minimizing the supply pressure effect and providing ease of use, depending on system needs.

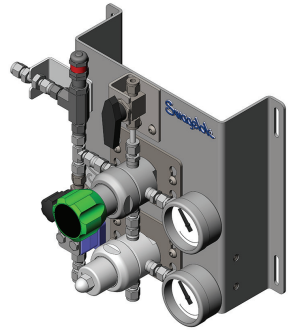

## Swagelok® Point-of- Use (SPU)

Swagelok® point-of-use system (SPU) is the last point of control prior to the gas being used. It is used at the end of the gas distribution system. Point-of-use systems supply gas to lab benches, vent hoods, and single or small collections of equipment.

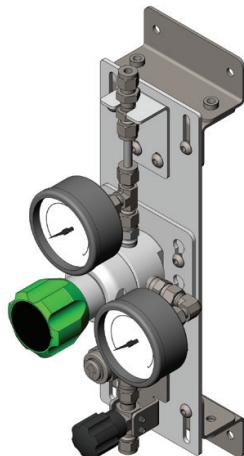

## Swagelok® Changeover (SCO)

A Swagelok® Changeover (SCO) is a special type of primary gas control system used when the continuous supply of gas is important. SCO automatically starts drawing from a secondary source of gas once the pressure of the primary source equals the set changeover pressure.

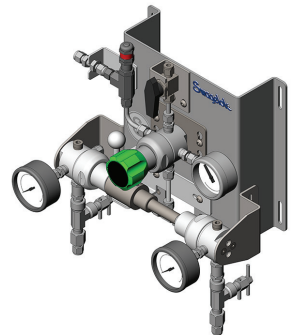



## Target industry:

- Oil and gas
- Chemical and refinery
- Pulp and paper
- Powerplant
- Food and beverages
- Pharmaceutical
- General Industry

## Application:

- Laboratory service
- Process analyzer
- Chromatography and analytical



For more information, please contact  
**[nusafluid.solusiutama@swagelok.co.id](mailto:nusafluid.solusiutama@swagelok.co.id)**, your local Swagelok sales and  
service center or visit our website **<https://indonesia.swagelok.com>**