

These instructions apply to **STRAIGHT and 3-WAY** pattern 83 and H83 series valves.

### Kit Contents



Locking handle



Lock plate



Set screw

### Suggested Tools



Torque wrench with  
3/32 in. hex adapter

or



3/32 in. hex key



Torque wrench with  
1 1/8 in. crows-foot  
adapter

or



1 1/8 in. open-end  
wrench or  
adjustable wrench

### Valve Preparation

Note direction of current handle. Locking handle must be installed pointing in the same direction as the current handle. Remove the set screw, current handle, and panel nut.

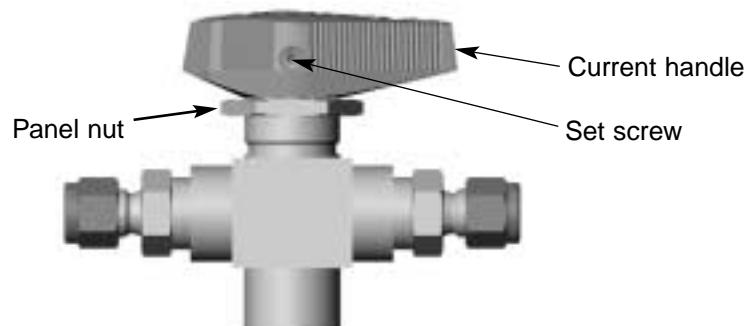

---

## Installation

Refer to Figure 1 during installation.

- 1.) Place lock plate over valve bonnet with protrusion side down. Rotate lock plate until protrusions on bottom engage with the valve body.
- 2.) Thread on panel nut. Tighten to wrench tight (reference 100 in.·lb, 11.3 N·m).
- 3.) Place locking handle onto the stem oriented in the same direction as the original handle. For 3-way pattern valves, the flow arrow marked on the top of the stem can also be used as a reference.
- 4.) Insert set screw into hole on locking handle. Tighten to 10 to 15 in.·lb (1.1 to 1.7 N·m).
- 5.) Lock plate holes will accommodate 1/4 in. (6.4 mm) to 5/16 in. (7.9 mm) lock shackle diameter and 3/4 in. (19.0 mm) minimum shackle length (Figure 2).

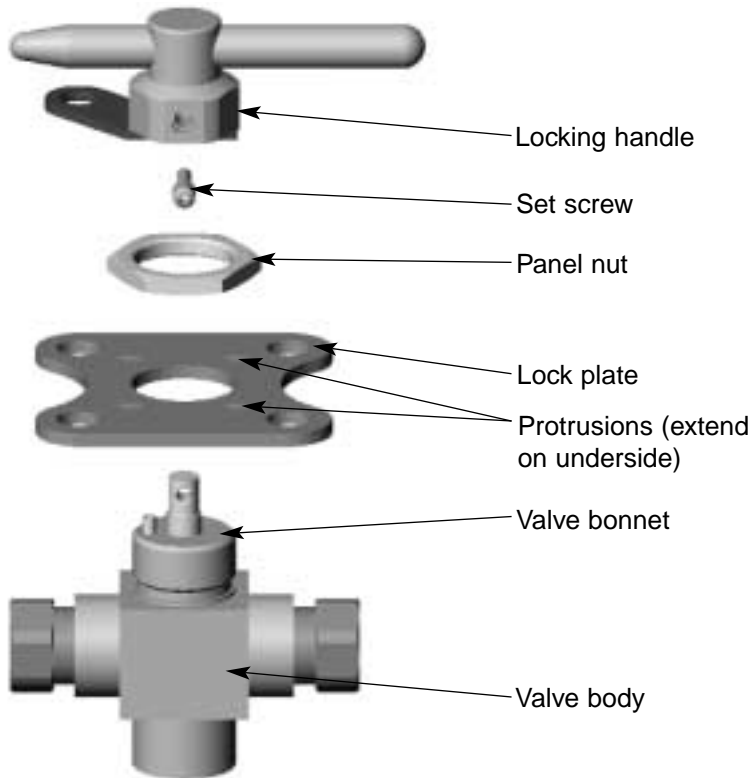

Figure 1

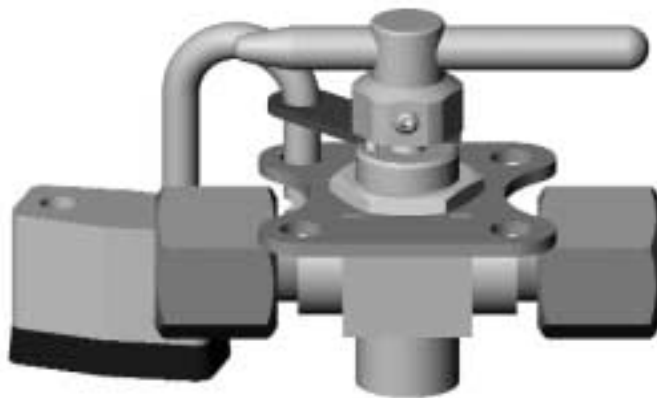

Figure 2