

# Filters and Strainers

## Service Instructions

### ⚠ WARNING

Before servicing any installed filter or strainer, you must depressurize the system.

The filter or strainer may contain residual system material.

### Inline Model

#### Disassembly

1. Gently push on the **outlet assembly** and remove the **clamp**. The inline model is spring loaded so the spring will force the outlet assembly away from the **body**. Lift the outlet assembly completely from the **body**.
2. Remove the **gasket** from the **outlet assembly** and inspect for damage or wear.
3. Remove the **backup tube**, the **filter element** and **retaining rings** (filters only), the **overscreen** (strainers only), the **spring**, and the **distributor cap** from the **outlet assembly**.

#### Cleaning

To ensure thorough cleaning, all components must be manually cleaned out of place (COP) prior to reassembly.

#### Filter Element Replacement

1. Remove both **retaining rings** from the ends of the **backup tube**, and slide the **filter element** off the backup tube.
2. Insert the new **filter element** over the **backup tube** and tuck the ends of the filter element over the ends of the backup tube. Insert the **retaining rings** inside each end of the backup tube.

#### Strainer Replacement

1. Slide the **overscreen** off the **backup tube** and clean or replace the overscreen.

#### Reassembly

1. Place the **backup tube** in the **outlet assembly**.
2. Press the **distributor cap** onto the **backup tube**.
3. Press the **spring** onto the outside diameter of the **distributor cap**.
4. Place the **gasket** on the **body**.
5. Press the **backup tube** into the **body** with the **outlet assembly** resting on top of the body.
6. Compress the entire assembly. Attach and tighten the **clamp**.

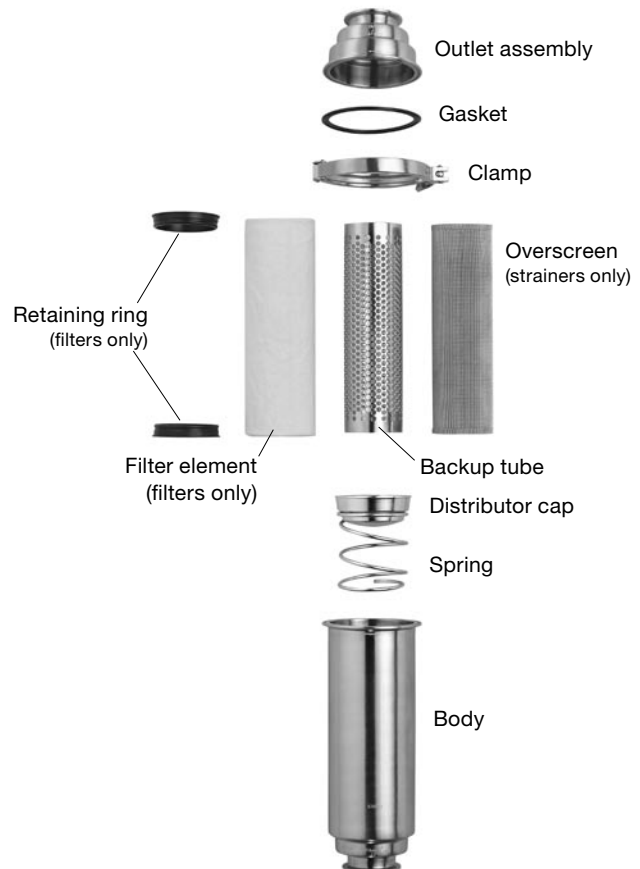

Swagelok

## Side-Inlet Model

### Disassembly

1. Gently push on the **outlet assembly** and remove the **clamp**. The side-inlet model is spring loaded so the **spring** will force the outlet assembly away from the **body**. Lift the outlet assembly away from the body.
2. Remove the **gasket** and inspect it for damage or wear.
3. Remove the **spring**, **distributor cap**, and **backup tube**.

### Cleaning

To ensure thorough cleaning, all components must be manually cleaned out of place (COP) prior to reassembly.

### Filter Element Replacement

1. Remove both **retaining rings** from the ends of the **backup tube**, and slide the **filter element** off the backup tube.
2. Insert the new **filter element** over the **backup tube** and tuck the ends of the filter element over the ends of the backup tube. Insert the **retaining rings** inside each end of the backup tube.

### Strainer Replacement

1. Slide the **overscreen** off the **backup tube** and clean or replace the overscreen.

### Reassembly

1. Insert the **backup tube** inside the **body** with the bottom of the backup tube seated firmly against the bottom of the body.
2. Insert the **distributor cap** inside the **body** ensuring that the cap is seated firmly against the top of the backup tube.  
Note: The opening on the handle of the distributor cap must face the opening of the inlet port to prevent blockage of the port.
3. Insert the **spring** inside the **body** so the spring is seated firmly against the ridge on the **distributor cap**.
4. Place the **gasket** on the **body**.
5. Compress the **outer assembly** onto the **body**. Attach and tighten the **clamp**.

